

Rec: \$19,50

513444

CERTIFICATE OF SIXTH AMENDMENT TO  
DECLARATION OF CONDOMINIUM OF  
TIMBER RIDGE VILLAGE I, A CONDOMINIUM

TIMBER RIDGE VILLAGE I, a Condominium, according to the Declaration of Condominium recorded in OR Book 705 at page 653, and as amended in OR Book 724 at page 1266, OR Book 747 at page 2773, OR Book 754 at page 0772, OR Book 762 at page 2488, and OR Book 0764 at page 0880 (this amendment being re-recorded to correct scrivener's error at OR Book 0765 at page 0480), all in the Public Records of Indian River County, Florida, hereby amends the Declaration of Condominium of Timber Ridge Village I, a Condominium, in compliance with Florida Statutes 718.104 and 718.110 to include the Certificate of Surveyor, attached hereto and made a part hereof as Exhibit "B", as to Buildings A-7 and B-4.

Executed at Vero Beach, Indian River County, Florida, this 7th day of July, 1987.

Witnesses:

*Pauline Cluikson*  
*Ky Bessette Cooper*  
As to both parties

TIMBER RIDGE, INC.

BY: *Andrew Mustapick* (SEAL)  
Andrew Mustapick, President

Attest: *Marilyn Mustapick* (SEAL)  
Marilyn Mustapick, Secretary

(CORPORATE SEAL)

STATE OF FLORIDA  
COUNTY OF INDIAN RIVER

I HEREBY CERTIFY that on this day, before me, an officer duly authorized in the state and county aforesaid to take acknowledgements, personally appeared ANDREW MUSTAPICK and MARILYN MUSTAPICK, well known to me to be the President and Secretary, respectively, of Timber Ridge, Inc., named in the foregoing instrument, and they acknowledged executing the same freely and voluntarily under authority duly vested in them by said corporation and the seal affixed to the foregoing instrument is the true corporate seal of the corporation.

WITNESS my hand and official seal in the state and county last aforesaid this 7th day of July, 1987.

(Notary seal)

*Ky Bessette Cooper*  
Notary Public, State of Florida at  
Large. My Commission Expires:

THIS INSTRUMENT PREPARED BY:

SAMUEL A. BLOCK, P.A.  
2127 10th Avenue  
Vero Beach, Florida 32960  
1-305-562-1600

*Patricia Ruff*

1987 JUL -8 PM 2 00

Record and Return to: Samuel A. Block, P.A.

EXHIBIT "B" TO DECLARATION OF CONDOMINIUM OF  
TIMBER RIDGE VILLAGE I, A CONDOMINIUM

CERTIFICATION:

THE UNDERSIGNED SURVEYING FIRM CERTIFIES THAT THE CONSTRUCTION OF THE IMPROVEMENTS TO COMPRISE BUILDINGS A-7 AND B-4, TIMBER RIDGE VILLAGE I, A CONDOMINIUM, IS SUBSTANTIALLY COMPLETE SO THAT THE MATERIAL WHICH COMPRISES THIS EXHIBIT "B" TO THE DECLARATION OF CONDOMINIUM OF TIMBER RIDGE VILLAGE I, A CONDOMINIUM, TOGETHER WITH THE PROVISIONS OF SAID DECLARATION OF CONDOMINIUM DESCRIBING THE CONDOMINIUM PROPERTY, ARE AN ACCURATE REPRESENTATION OF THE LOCATION AND DIMENSIONS OF SAID IMPROVEMENTS, AND THE IDENTIFICATION, LOCATION, AND DIMENSIONS OF THE COMMON ELEMENTS WITHIN THE CONDOMINIUM AND OF EACH UNIT WITHIN THE CONDOMINIUM CAN BE DETERMINED FROM SAID MATERIALS. FURTHER, ALL PLANNED IMPROVEMENTS, INCLUDING, BUT NOT LIMITED TO LANDSCAPING, UTILITY SERVICES AND ACCESS TO BUILDINGS A-7 AND B-4 COMMON ELEMENT FACILITIES SERVING BUILDINGS A-7 AND B-4 AS SET FORTH IN SAID DECLARATION ARE SUBSTANTIALLY COMPLETED.

CCL CONSULTANTS, INC.

7/1/87  
DATE

  
ISHMAEL S. MOHAMED  
Registered Land Surveyor No. 2464  
State of Florida

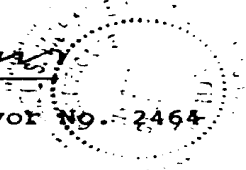
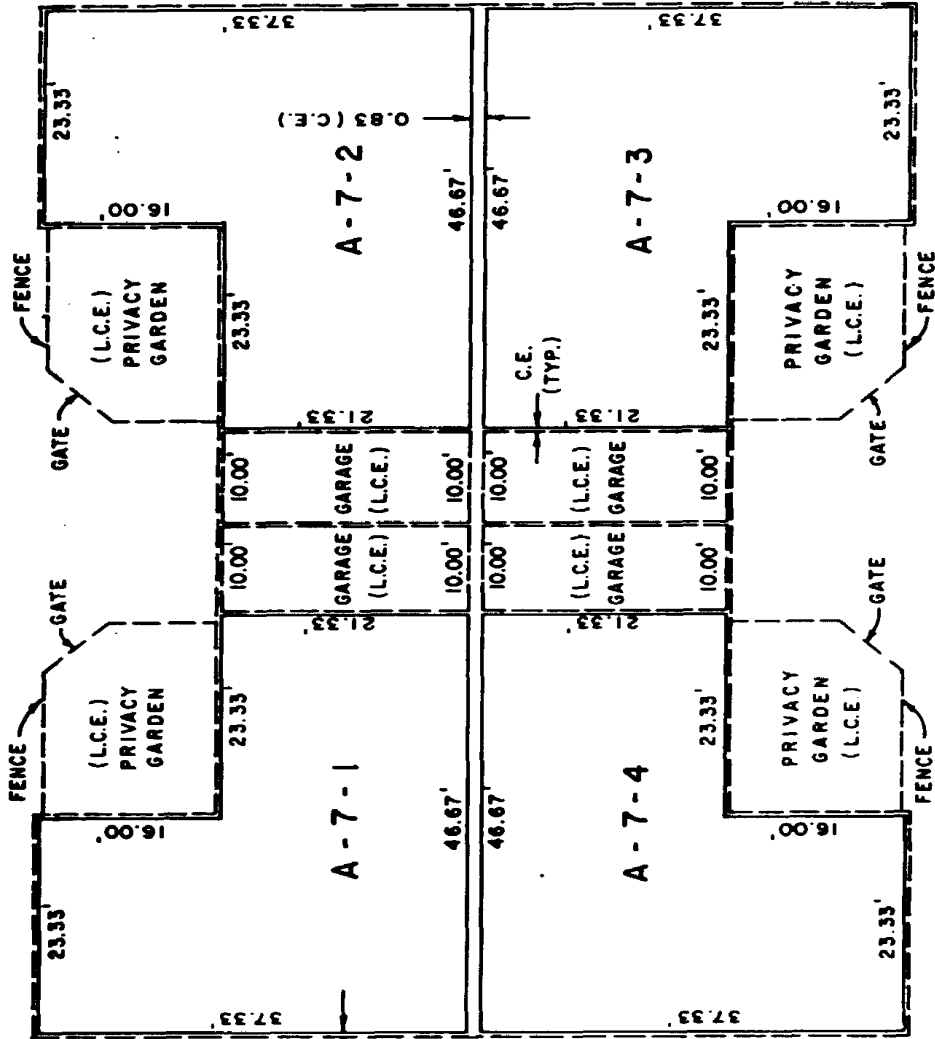

EXHIBIT "B" TO THE DECLARATION OF CONDOMINIUM OF  
**TIMBER RIDGE VILLAGE I - A CONDOMINIUM**  
**BUILDING A - 7**



O.R. 0772 PG 2811

**LEGEND:**

- (C.E.) Indicates Common Element
- (L.C.E.) Indicates Limited Common Element
- Indicates Unit Boundaries

**DESCRIPTION OF COMMON ELEMENTS**

1. All land and all portions of condominium property not within any unit or units, are parts of the common elements.
  2. All boarding walls to the unfinished surface of said walls located within a unit, constitute parts of the common elements.
  3. All conduits and wires to outlets, all other utility lines to outlets and all waste pipes, regardless of location, constitute parts of the common elements.
  4. The common elements are subject to certain easements set forth in the declaration including ingress and egress to public ways.
- N.B.T.E: The definitions set forth in the declaration are incorporated herein.



UPPER LIMITS OF UNIT 30.70 M.S.L. ELEV.  
 LOWER LIMITS OF UNIT 22.70 M.S.L. ELEV.

7-1-87 "AS-BUILT" M.D.

C.C.L. CONSULTANTS, INC.  
 40 EAST LAMAR ROAD, SUITE 100  
 CHARLOTTE, NORTH CAROLINA 28202  
 PROJECT NO. 87-001  
**TIMBER RIDGE VILLAGE I**  
 A CONDOMINIUM  
 BUILDING A-7  
 DATE: 7/1/87

EXHIBIT "B" TO THE DECLARATION OF CONDOMINIUM OF  
**TIMBER RIDGE VILLAGE I - A CONDOMINIUM**

**BUILDING B-4**

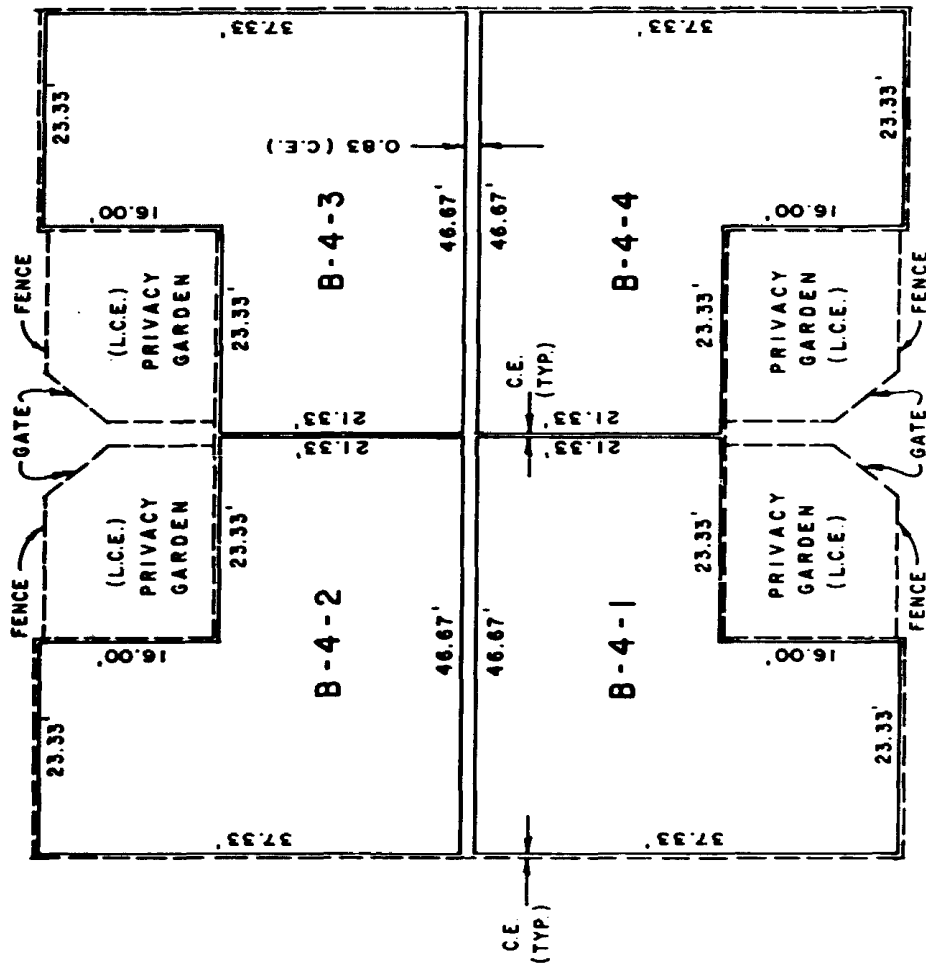

**LEGEND:**

- (CE) Indicates Common Element
- (L.C.E.) Indicates Limited Common Element
- Indicates Unit Boundaries

**DESCRIPTION OF COMMON ELEMENTS**

1. All land and all portions of condominium property not within any unit or units, are parts of the common elements.
2. All bearing walls to the unfinished surface of said walls located within a unit, constitute parts of the common elements.
3. All conduits and wires to outlets, all other utility lines to outlets and all waste pipes, regardless of location, constitute parts of the common elements.
4. The common elements are subject to certain easements set forth in the declaration including ingress and egress to public ways.

NOTE: The definitions set forth in the declaration are incorporated herein.



UPPER LIMITS OF UNIT 30.60 M.S.L. ELEV.  
 LOWER LIMITS OF UNIT 22.80 M.S.L. ELEV.

7-1-87 "AS-BUILT" M.D.

**CCL CONSULTANTS, INC.**  
 1000 WEST 10TH AVENUE, SUITE 100  
 DENVER, COLORADO 80202  
 TEL: 303-733-1100  
 FAX: 303-733-1101

**TIMBER RIDGE VILLAGE I**  
 A CONDOMINIUM  
 BUILDING B-4

DATE: 7/1/87  
 DRAWN BY: [Signature]