

Rec. #13⁰⁰
Re-record #13⁰⁰

500429

501698

CERTIFICATE OF FIFTH AMENDMENT TO
DECLARATION OF CONDOMINIUM OF
TIMBER RIDGE VILLAGE #1, A CONDOMINIUM

1981 APR -8 PM 4 27
INDIAN RIVER COUNTY
CLERK OF COUNTY COURT
VERO BEACH, FLA.
RECORDED
INDEXED

TIMBER RIDGE VILLAGE #1, a Condominium, according to the Declaration of Condominium recorded in OR Book 705 at page 653, and as amended in OR Book 724 at page 1266, OR Book 747 at page 2773, OR Book 754 at page 0772, and OR Book 762 at page 2488, all in the Public Records of Indian River County, Florida, hereby amends the Declaration of Condominium of Timber Ridge Village I, a Condominium, in compliance with Florida Statutes 718.104 and 718.110 to include the Certificate of Surveyor, attached hereto and made a part hereof as Exhibit "B", as to Building A-4.

Executed at Vero Beach, Indian River County, Florida this 27th day of March, 1987.

Witnesses:

[Signature]

TIMBER RIDGE, INC.

By [Signature] Seal
Andrew Mustapick, President

[Signature]
As to both parties

Attest [Signature] Seal
Marilyn Mustapick, Secretary

(CORPORATE SEAL)

STATE OF FLORIDA
COUNTY OF INDIAN RIVER

I HEREBY CERTIFY that on this day, before me, an officer duly authorized in the state and county aforesaid to take acknowledgments, personally appeared ANDREW MUSTAPICK and MARILYN MUSTAPICK, well known to me to be the President and Secretary, respectively, of Timber Ridge, Inc., named in the foregoing instrument, and they acknowledged executing the same freely and voluntarily under authority duly vested in them by said corporation and the seal affixed to the foregoing instrument is the true corporate seal of the corporation.

WITNESS my hand and official seal in the state and county last aforesaid this 27th day of March, 1987.

[Signature]
Notary Public, State of Florida at Large. My Commission Expires:

Notary Public, State of Florida
My Commission Expires May 26, 1983
Bonded thru Troy Fair - Insurance, Inc.

THIS INSTRUMENT PREPARED BY:
SAMUEL A. BLOCK, PA/tw
2127 - 10th Avenue
Vero Beach, Florida 32960
1-305-562-1600

THIS CERTIFICATE OF AMENDMENT RE-RECORDED TO CORRECT SCRIVENER'S ERROR IN NUMBER OF AMENDMENT TO READ: CERTIFICATE OF FIFTH AMENDMENT TO DECLARATION OF CONDOMINIUM OF TIMBER RIDGE VILLAGE #1, A CONDOMINIUM.

O.R. 0764 PG 0880

O.R. 0765 PG 0480

C & -RECORD AND RETURN TO SAMUEL A. BLOCK, PA/tw

EXHIBIT "B" TO DECLARATION OF CONDOMINIUM OF
TIMBER RIDGE VILLAGE I, A CONDOMINIUM

CERTIFICATION:

THE UNDERSIGNED SURVEYING FIRM CERTIFIES THAT THE CONSTRUCTION OF THE IMPROVEMENTS TO COMPRISE BUILDING A-4, TIMBER RIDGE VILLAGE I, A CONDOMINIUM, IS SUBSTANTIALLY COMPLETE SO THAT THE MATERIAL WHICH COMPRISES THIS EXHIBIT "B" TO THE DECLARATION OF CONDOMINIUM OF TIMBER RIDGE VILLAGE I, A CONDOMINIUM, TOGETHER WITH THE PROVISIONS OF SAID DECLARATION OF CONDOMINIUM DESCRIBING THE CONDOMINIUM PROPERTY, ARE AN ACCURATE REPRESENTATION OF THE LOCATION AND DIMENSIONS OF SAID IMPROVEMENTS, AND THE IDENTIFICATION, LOCATION, AND DIMENSIONS OF THE COMMON ELEMENTS WITHIN THE CONDOMINIUM AND OF EACH UNIT WITHIN THE CONDOMINIUM CAN BE DETERMINED FROM SAID MATERIALS. FURTHER, ALL PLANNED IMPROVEMENTS, INCLUDING, BUT NOT LIMITED TO LANDSCAPING, UTILITY SERVICES AND ACCESS TO BUILDING A-4 COMMON ELEMENT FACILITIES SERVING BUILDING A-4 AS SET FORTH IN SAID DECLARATION ARE SUBSTANTIALLY COMPLETED.

CCL CONSULTANTS, INC.

3/27/87
DATE

I. Mohamed
ISHMAEL S. MOHAMED
Registered Land Surveyor
No. 2464
State of Florida



EXHIBIT "B" TO THE DECLARATION OF CONDOMINIUM OF
TIMBER RIDGE VILLAGE I - A CONDOMINIUM
BUILDING A - 4

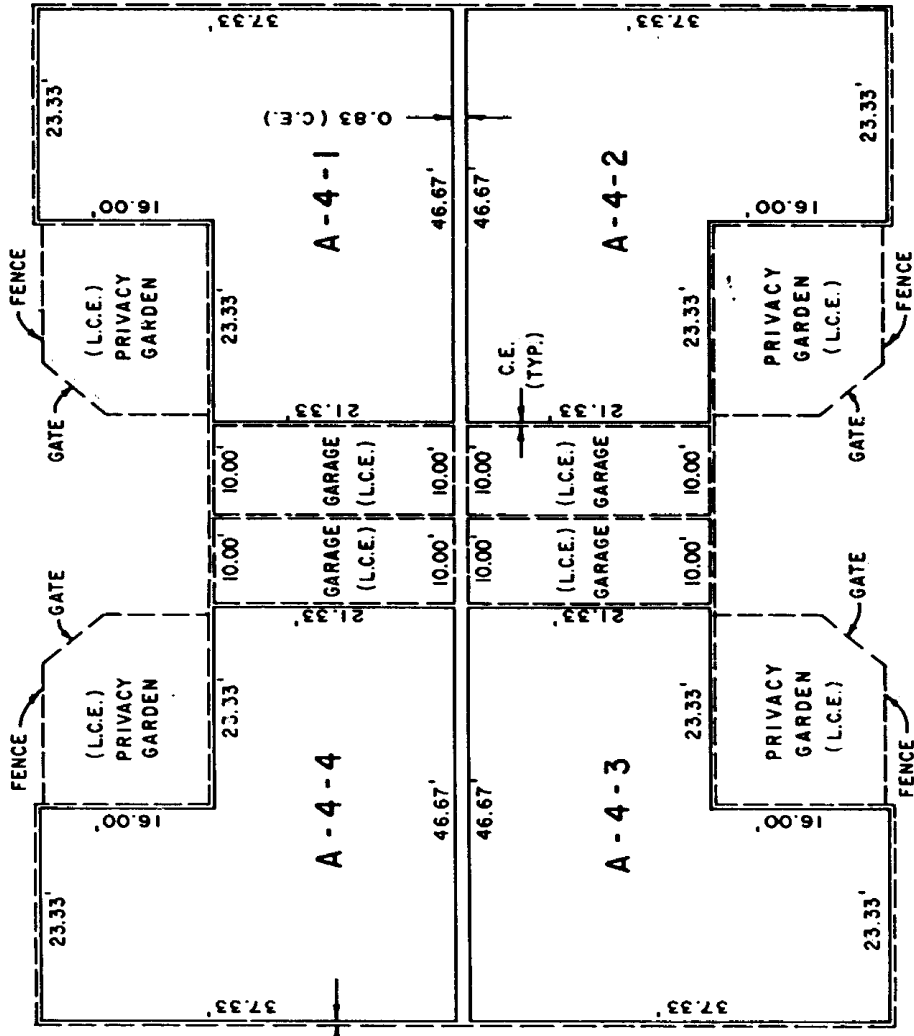

1987 MAR 30 PM 2:47
 CLINTON D. ...
 ...

- LEGEND:**
- (CE) Indicates Common Element
 - (LCE) Indicates Limited Common Element
 - Indicates Unit Boundaries

DESCRIPTION OF COMMON ELEMENTS

1. All land and all portions of condominium property not within any unit or units, are parts of the common elements.
2. All boarding walls to the unfinished surface of said walls located within a unit, constitute parts of the common elements.
3. All conduits and wires to outlets, all other utility lines to outlets and all waste pipes, regardless of location, constitute parts of the common elements.
4. The common elements are subject to certain easements set forth in the declaration including ingress and egress to public ways.

NOTE: The definitions set forth in the declaration are incorporated herein.



UPPER LIMITS OF UNIT 31.60 M.S.L. ELEV.
 LOWER LIMITS OF UNIT 23.60 M.S.L. ELEV.

3-20-87 "A-5-BUILT" M.D.

C.C.L. CONSULTANTS, INC.
 1401 EAST BAYVIEW AVENUE, SUITE 1100
 MIAMI BEACH, FLORIDA 33137

TIMBER RIDGE VILLAGE I
 A CONDOMINIUM
 BUILDING A-4